



TECHNICAL CHARACTERISTICS

- Aluminium alloy construction
- Smooth operation
- High efficiency impeller
- Maintenance free
- Mountable in any position

OPTIONS

- Special voltages (IEC 38)
- Surface treatments

Possible alternative positions, please refer to drw SI 1835

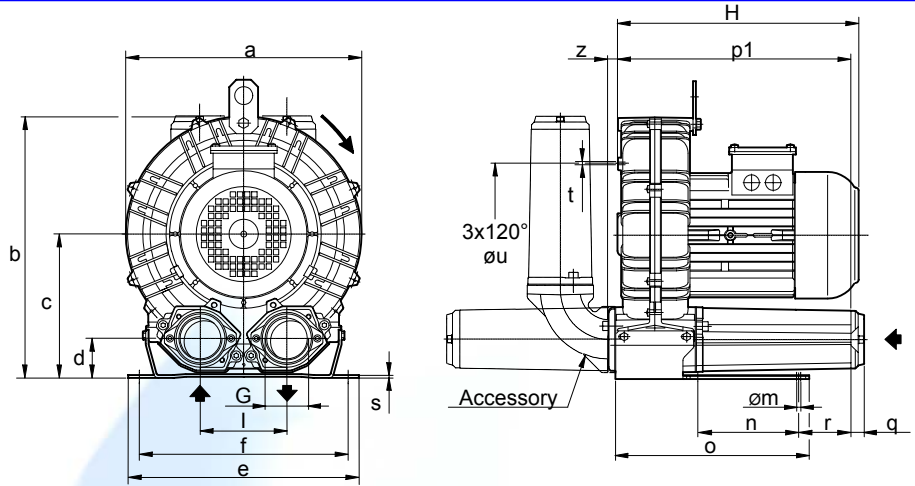

Dimensions in mm

Model	a	b	c	d	e	f	G	l	m	n	o	p1	q	r	s	t	u	z
K03-MS	241	268	147	43	230	205	G 1" 1/4	86	10	83	142	205	18	75	4	M6	140	12
K04-MS	285	315	172	49	255	225	G 1" 1/2	102	12	95	171	222	18	70	4	M6	175	18
K05-MS	327	365	200	54	320	260	G 2"	120	15	115	265	320	18	98	4	M8	200	19
K06-MS	376	393	205	54	325	290	G 2"	125	15	140	265	334	18	85	4	M8	240	19

Model	Maximum flow m³/h		Installed power kW		Maximum differential pressure Δp hPa (mbar)		Noise level Lp dB (A) (1)		Overall dimensions H mm	Weight Kg		
	50 Hz 2900 rpm	60 Hz 3500 rpm	50 Hz 2900 rpm	60 Hz 3500 rpm	50 Hz 2900 rpm	60 Hz 3500 rpm	50 Hz 2900 rpm	60 Hz 3500 rpm				
K03-MS	74	89	0.37	0.43	130	120	59.7	61.7	241	11.0		
			0.55	0.63	150	170	60.0	62.0			241	12.0
K04-MS	137	166	0.75	0.9	140	120	62.6	64.6	282	15.8		
			1.1	1.3	200	175	62.8	64.8			282	16.5
			1.5	1.75	250	250	63.0	65.0			310	19.5
K05-MS	219	265	1.1	1.3	130	100	68.2	70.2	307	22.5		
			1.5	1.75	175	160	68.5	70.5			307	23.5
			2.2	2.55	270	260	68.8	70.8			330	26.5
			3.0	3.45	300	350	69.1	71.1			375	30.5
K06-MS	304	366	2.2	2.55	180	150	71.0	73.0	367	31.2		
			3.0	3.45	250	220	71.3	73.3			367	32.5
			4.0	4.6	340	325	71.6	73.6			367	35.2

(1) Noise measured at 1 m distance with inlet and outlet ports piped, in accordance to ISO 3744.

- For proper use, the blower should be equipped with inlet filter and safety valve; other accessories available on request.
- Ambient temperature from -15° to +40°C.
- Specifications subject to change without notice.

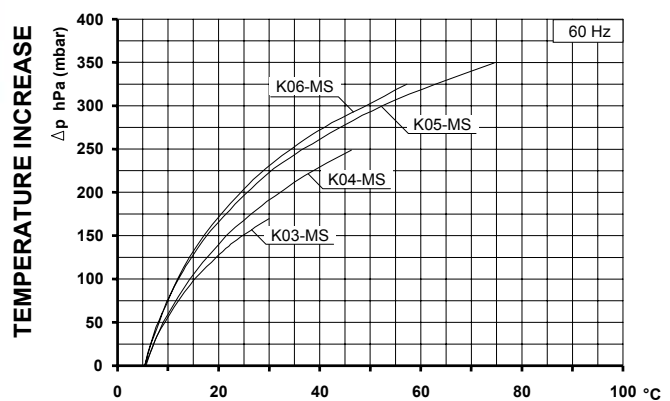
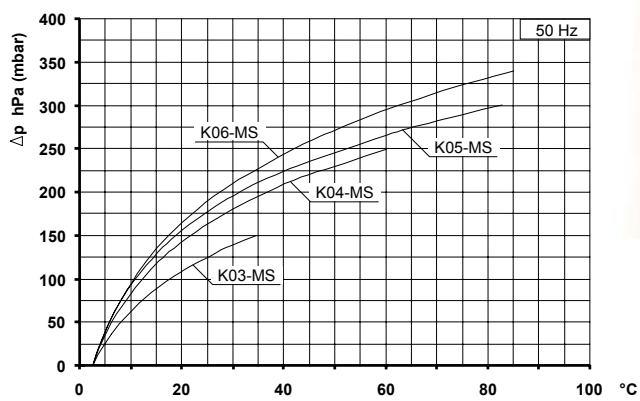
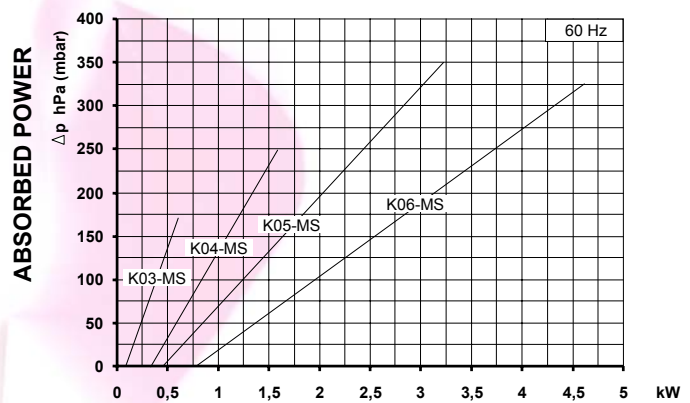
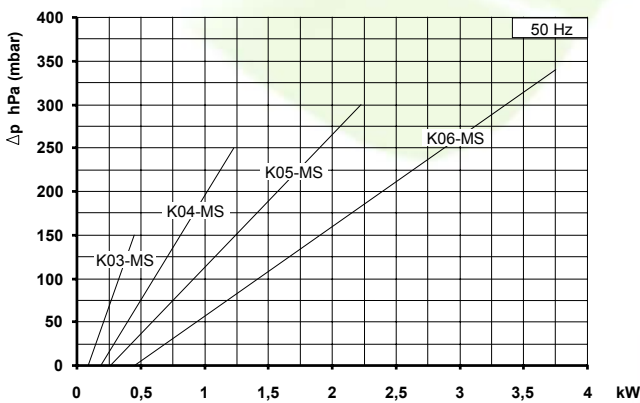
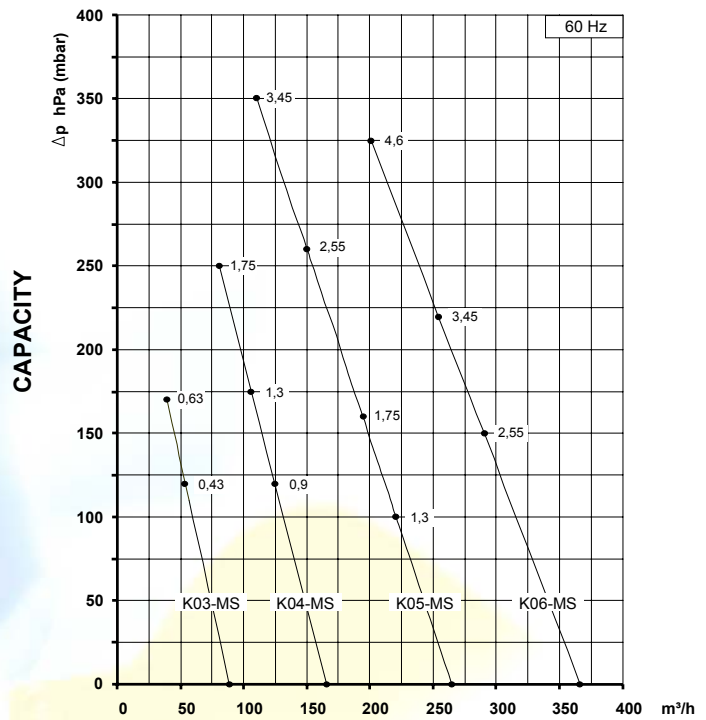
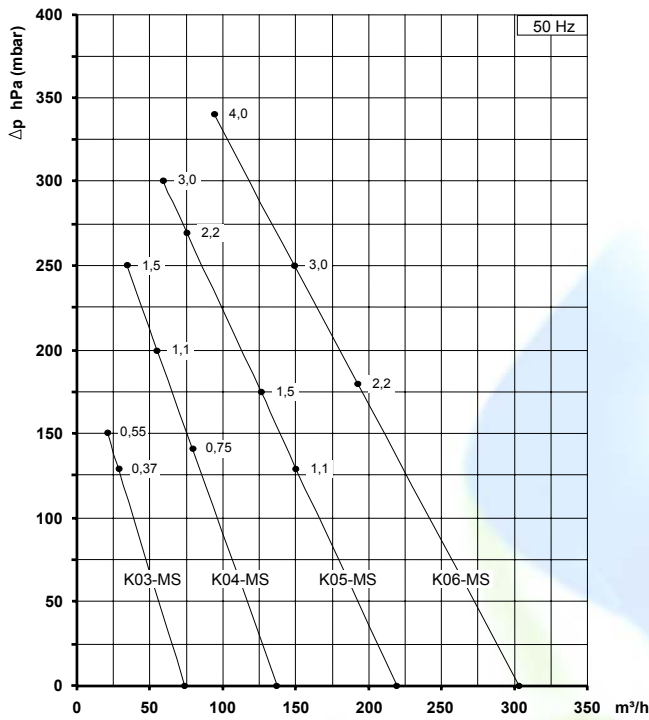

Curves refer to air at 20°C temperature and 1013 mbar (abs) atmospheric pressure measured at inlet port.
 Values for flow, power consumption and temperature rise: +/-10% tolerance.
 Data can change without prior notice.



TECHNICAL CHARACTERISTICS

- Aluminium alloy construction
- Smooth operation
- High efficiency impeller
- Maintenance free
- Mountable in any position

OPTIONS

- Special voltages (IEC 38)
- Surface treatments

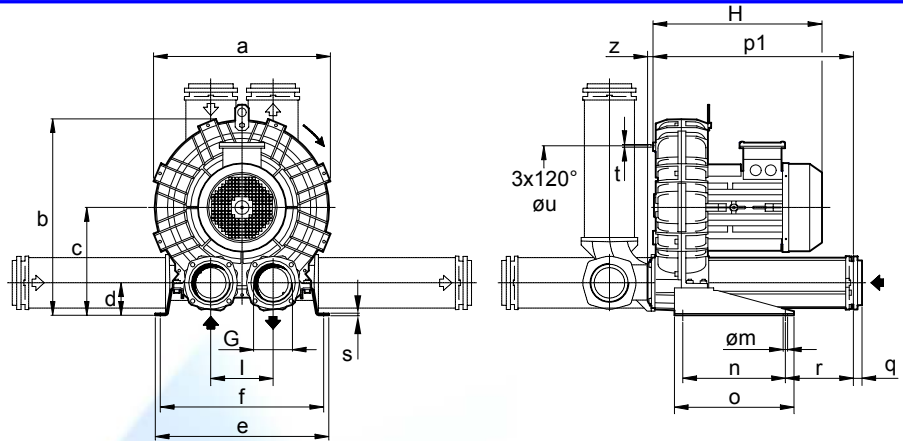

Possible alternative positions,
 please refer to drw SI 1818

Dimensions in mm

Model	a	b	c	d	e	f	G	l	m	n	o	p1	q	r	s	t	u	z
K07-MS	424	481	269	82	468	438	G 3"	155	13	300	350	512	25	137	5	M8	295	16
K08-MS	457	498	269	82	478	448	G 3"	155	13	300	350	512	25	137	5	M8	310	16
K09-MS	492	561	315	96	508	478	G 4"	182	13	300	350	586	25	199	5	M8	360	16
K10-MS	516	573	315	96	508	478	G 4"	182	13	300	350	586	25	199	5	M8	360	16
K11-MS	542	603	332	91	538	508	G 4"	200	13	300	350	596	25	204	5	M8	390	16

Model	Maximum flow m ³ /h		Installed power kW		Maximum differential pressure Δp hPa (mbar)		Noise level Lp dB (A) (1)		Overall dimensions H mm	Weight Kg
	50 Hz 2900 rpm	60 Hz 3500 rpm	50 Hz 2900 rpm	60 Hz 3500 rpm	50 Hz 2900 rpm	60 Hz 3500 rpm	50 Hz 2900 rpm	60 Hz 3500 rpm		
K07-MS	414	500	2.2	2.55	130	100	76.4	78.4	410	46.5
			3.0	3.45	200	175	76.7	78.7		
			4.0	4.6	280	250	77.0	79.0		
			5.5	6.3	400	375	77.3	79.3		
			-	8.7	-	450	-	79.6		
K08-MS	536	647	3.0	3.45	125	100	77.4	79.4	410	49.0
			4.0	4.6	180	150	77.7	79.7		
			5.5	6.3	275	250	78.0	80.0		
			7.5	8.7	400	375	78.3	80.3		
			9.2	10.6	450	450	78.6	80.6		
K09-MS	663	800	4.0	4.6	130	85	78.0	80.0	420	62.0
			5.5	6.3	210	150	78.2	80.2		
			7.5	8.7	290	250	78.5	80.5		
			9.2	10.6	350	325	78.7	80.7		
			11	12.7	450	400	79.0	81.0		
			-	17.4	-	500	-	81.3		
K10-MS	782	944	5.5	6.3	160	115	78.1	80.1	455	75.0
			7.5	8.7	250	200	78.5	80.5		
			9.2	10.6	300	270	79.0	81.0		
			11	12.7	400	375	79.4	81.4		
			15	17.4	500	500	79.6	81.6		
K11-MS	915	1105	5.5	-	100	-	78.5	-	460	78.5
			7.5	8.7	175	130	80.0	82.0		
			9.2	10.6	230	175	80.1	82.1		
			11	12.7	300	250	80.4	82.4		
			15	17.4	400	350	80.7	82.7		
			18.5	21.5	500	500	83.6	85.6		

(1) Noise measured at 1 m distance with inlet and outlet ports piped, in accordance to ISO 3744.

- For proper use, the blower should be equipped with inlet filter and safety valve; other accessories available on request.
- Ambient temperature from -15° to +40°C.
- Specifications subject to change without notice.

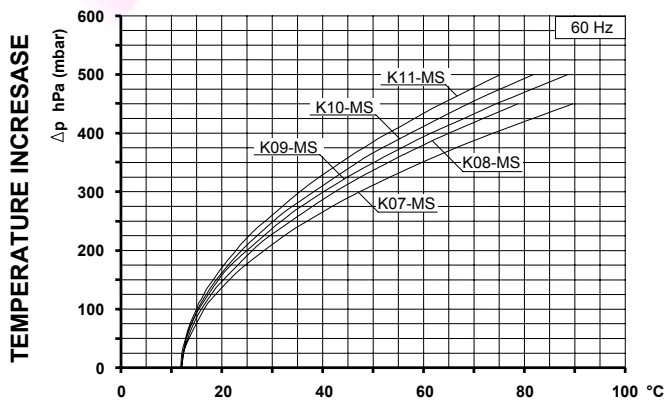
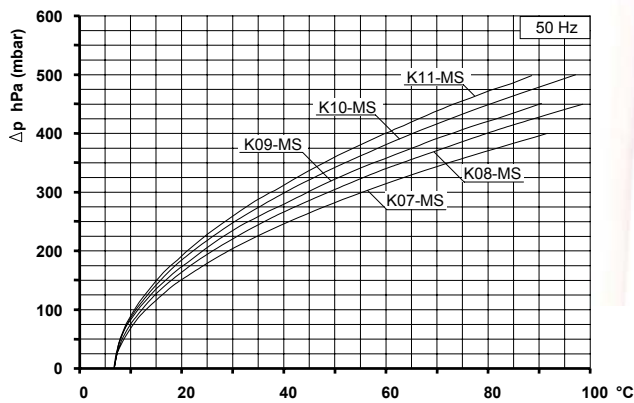
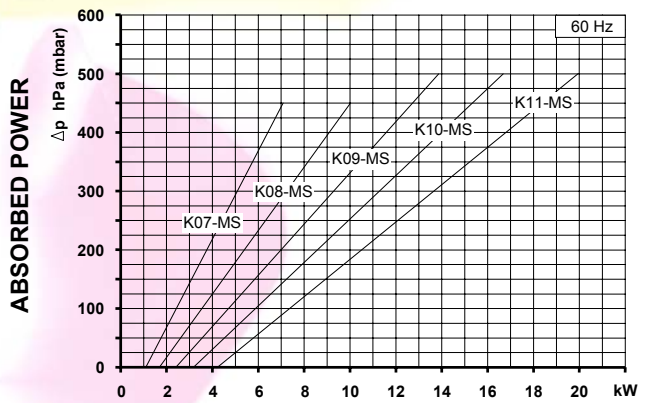
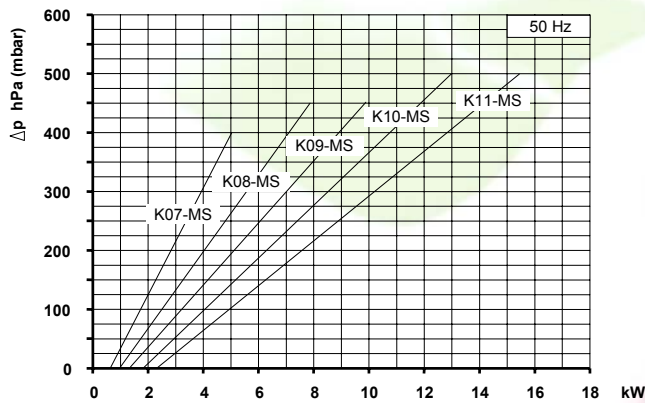
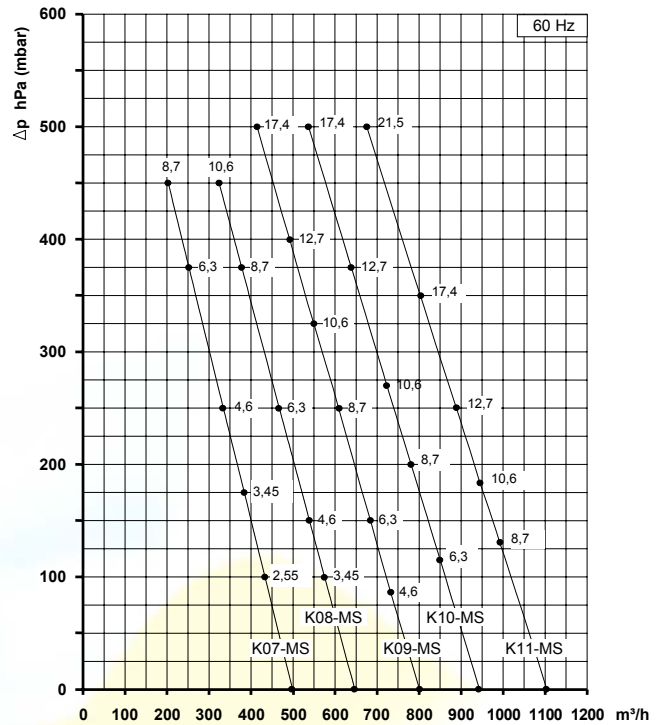
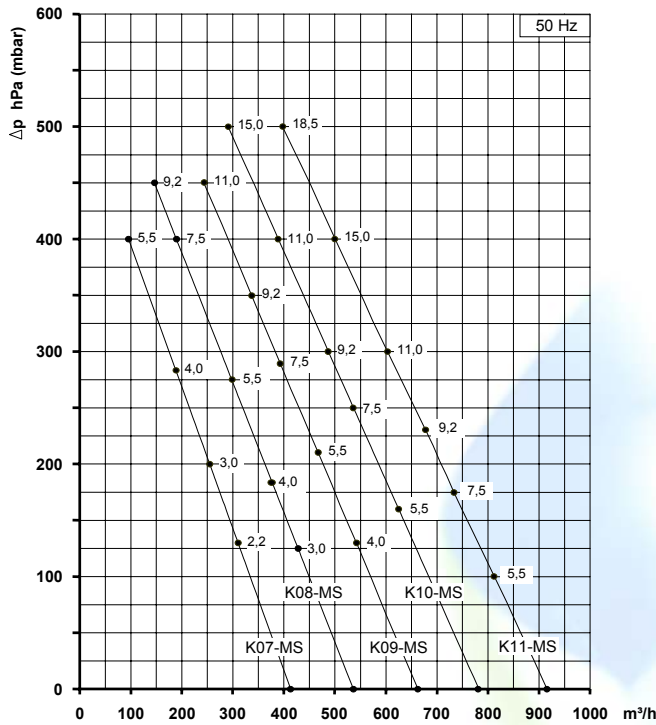

Curves refer to air at 20°C temperature and 1013 mbar (abs) atmospheric pressure measured at inlet port.

Tolerance on given values: ± 10%.

Data can change without prior notice.